

Z33/...

Mat.: 8.8/800 N/mm²
DIN EN 10642 (DIN 7991)

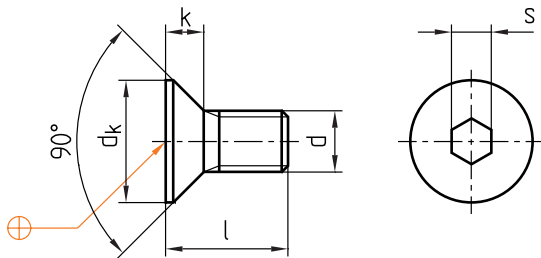

s	dk	k	d	l	Nr./No.
2,5	8	2,3	M4	8	Z33/4x 8
				10	10
				12	12
				16	16
				20	20
3	10	2,8	M5	8	Z33/5x 8
				10	10
				12	12
				14	14
				16	16
4	12	3,3	M6	12	Z33/6x12
				16	16

s	dk	k	d	l	Nr./No.
4	12	3,3	M 6	20	Z33/ 6x20
				25	25
				30	30
				12	Z33/ 8x12
5	16	4,4	M 8	16	16
				20	20
				25	25
				30	30
6	20	5,5	M10	20	Z33/10x20
8	24	6,5	M12	20	Z33/12x20
				30	30

Z34/...

Mat.: min. 1455 N/mm²
DIN 915 - 45 H / ≈ ISO 4028

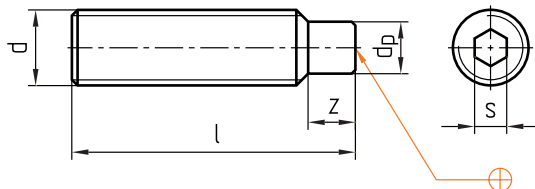

s	z	dp	d	l	Nr./No.
2	2	2,5	M 4	10	Z34/ 4x10
3	3	4	M 6	18	6x18
				25	6x25
				20	8x20
4	4	5,5	M 8	30	8x30
				10	10x30

s	z	dp	d	l	Nr./No.
5	5	7	M10	40	Z34/10x40
				50	10x50
6	7	8,5	M12	30	12x30
				40	12x40
8	8	12	M16	45	16x45
				55	16x55

This is trial version
www.adultpdf.com